



Technical data sheet

EOSafe L

Safety system for saunas with remote switching and timer-based operation.

Safety system for supervision of the sauna heater with a light barrier, consisting of the ceiling-mounted light emitter / receiver, heater-mounted reflector lens and the central electronic unit. In combination with the suitable EOS sauna control unit EOSafe can detect if the sauna heater has been switched on in unsafe condition, e.g. with a towel forgotten on it, and stop the heating process.

Your benefits:

- Reliable detection if the sauna heater is completely covered upon switching on.
- Up to 4 light barriers can be connected to the main controller. Which can be mounted on one heater or on four separate heaters.
- Sauna heater can be installed anywhere in the sauna cabin.
- Simple, straightforward configuration in the main controller, or also via the EmoTouch 3 display panel.
- Makes sauna compliant with the current EN safety norms.
- VDE approved in combination with EOS heaters and controls.
- Made in Germany quality from EOS.

Features and specifications:

Components:	Light barrier (emitter / receiver) for ceiling installation over the heater with 5 m sauna bus cable. Reflector lens (27 mm / 52 mm) with stainless steel holder for mounting on the heater. Controller with pre-mounted mains cable.
Max. gap from ceiling to reflector lens:	Ø 27 mm reflector = 1,5 m Ø 52 mm reflector = 2,25 m
Operation temperature for light barrier/reflector:	-10 °C to 140 °C
Power supply:	230 V N ~ 50 Hz
Protection class:	IPX4



Compatible sauna heaters:

- | | |
|----------------------------|---------------------------------|
| • BlackRock | • Selection / Bi-O Selection |
| • Cubo / Cubo+ / Bi-O Cubo | • Herkules S60 / S60 Vapor |
| • Cubo Avantgarde (45°) | • Herkules XL S120 / S120 Vapor |
| • Credo | • Mythos S35 / S45 |
| • Gracil / Gracil W | • Goliath |
| • Herkules S25 / S25 Vapor | • 34.G |
| • Moment W | • Orbit |
| • Stone S25 / S25 Vapor | • Zeus / S / SL / L |



Example: reflector on the Goliath sauna heater.

Installation overview

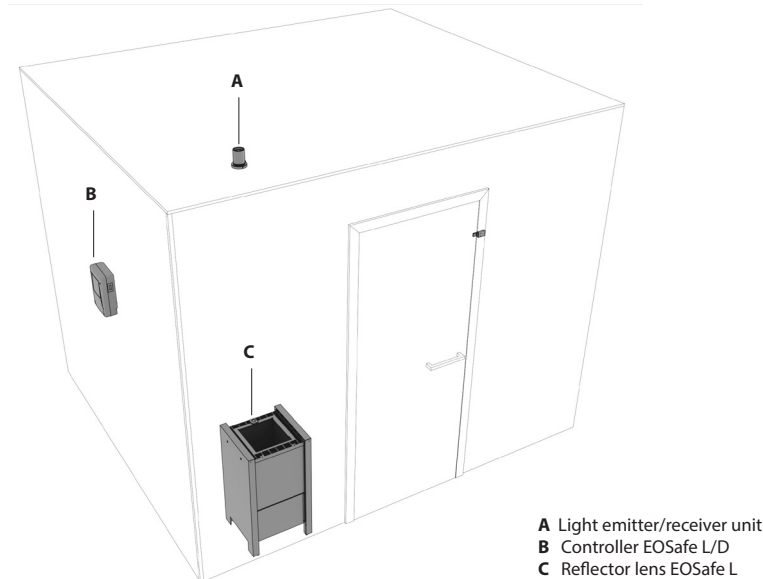

Connection overview

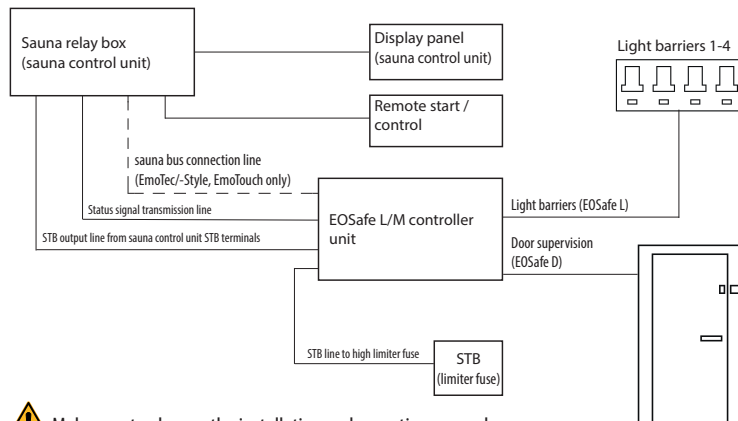

! Make sure to observe the installation and operation manual.

Accessories (optional)

Sauna bus cables (EmoTec / EmoStyle / EmoTouch)	Item no.
Connection cable „sauna bus“ 10 m (RJ12/RJ12)	94 5861
Connection cable „sauna bus“ 25 m (RJ12/RJ12)	94 4647
Connection cable „sauna bus“ 50 m (RJ12/RJ12)	94 4648

Accessories for EOSafe L	Item no.
EOSafe L light emitter & receiver unit, with housing	94 6981
Reflector lens 52 mm with stainless steel holder	94 6983
Reflector lens 27 mm with stainless steel holder	94 6984

EOSafe L components

EOSafe L light emitter & receiver unit

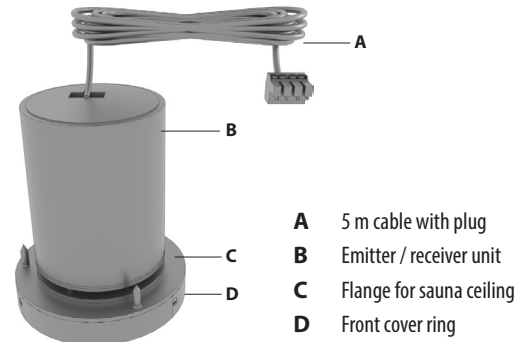

Reflector lens

Available as Ø27 mm or Ø52 mm version. Installation with the included stainless steel holder.

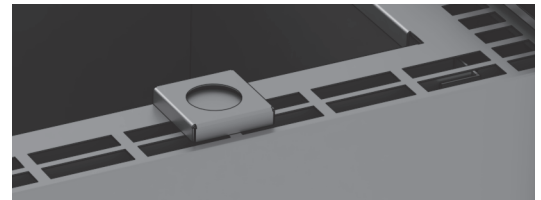

EOSafe L/D main controller (inner view)

