

# Infrared Heating Foils

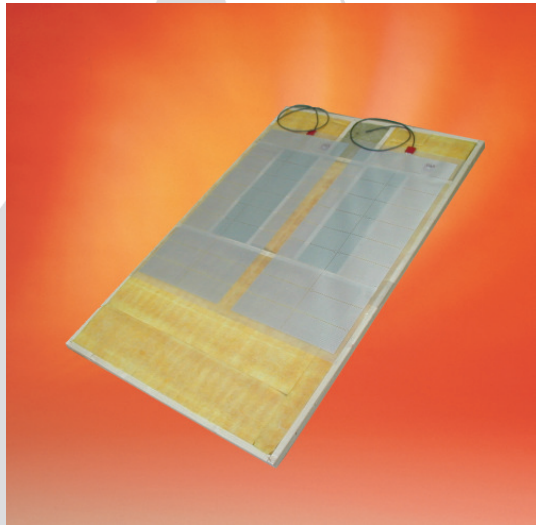

**(GB) Assembly and operating instruction**

**MADE IN GERMANY**



# English

## Table of Contents

Technical data: .....	3
Important notes: .....	4
Design and installation of IR foils (heating mats): .....	5
Example of arrangement .....	5
Layout .....	5
Operating principle .....	5
Electrical connection .....	6
Possible connection schematic .....	6
Start-up .....	6
Connection with InfraTouch .....	7
Service Address: .....	8
Guarantee .....	8
Handling procedures for return shipments (RMA) - Details for all returns ! .....	9

## Technical data:

Voltage: 230 V 50Hz

Use the control unit 60 IR, Infratec Classic or InfraTouch.

### Type 1

Output: 650 W  
Dimensions foil: 1700 x 800 mm  
Dimensions heating surface: 1620 x 720 mm

### Type 2

Output: 550 W  
Dimensions foil: 1450 x 800 mm  
Dimensions heating surface: 1370 x 720 mm

### Type 3

Output: 450 W  
Dimensions foil: 1600 x 600 mm  
Dimensions heating surface: 1520 x 520 mm

### Type 4

Output: 350 W  
Dimensions foil: 1250 x 600 mm  
Dimensions heating surface: 1170 x 520 mm

### Type 5

Output: 275 W  
Dimensions foil: 1600 x 400 mm  
Dimensions heating surface: 1520 x 320 mm

### Type 6

Output: 90 W  
Dimensions foil: 600 x 300 mm  
Dimensions heating surface: 520 x 220 mm

### Type 7

Output: 200-225 W  
Dimensions foil: 1600 x 300 mm  
Dimensions heating surface: 1520 x 220 mm



## Important notes:



The heating foils pose a fire hazard when not installed properly. Please read these installation instructions thoroughly. Pay particular attention to the dimensions specified and the following instructions:

- The infrared heating foils are designed for connection to 230 V 50 Hz over an infrared control unit.
- Install and connect the infrared control unit according to the connection schematic.
- Before putting the foils into operation with the control unit, ensure that all plug connectors are connected so they cannot loosen.
- Observe regulations in EU 60335-2-53 (VDE 0700 Part 53) inside the infrared booth.
- Install only the number of heating foils in the infrared heat booth specified for the booth size.
- Use one of the control units specified below for control of the infrared radiators. Install this control unit on the infrared heat booth as specified in the installation instructions for the control unit.
- Install the heating foils in the booth to achieve uniform heat radiation all around for the person in the booth.
- The infrared heating foils are not suitable for installation in the booth ceiling and should not be installed there.
- Note that the energy is output primarily in the form of infrared radiation.
- The infrared heating foils are equipped with a silicone connection cable with three-pin plug. Connect this plug to a free outlet on the connector for the IR

control unit.

When connecting ensure that the circuit breaker is secured against unintentional actuation.

- On a standard basis five infrared heating foils can be connected to this plug-in distribution. Do not exceed the maximum power of 3500 W. It is most practical to attach the plug connector to the ceiling of the booth.
- Never cut open heating foils open or in two. Operate only in the fixed dimensions available.
- This device has not been designed for being used by persons (including children) that are physically or mentally handicapped or have sensory disabilities. Moreover, it is not allowed to use this device without sufficient experience and/or knowledge, unless these persons will be supervised by persons responsible for their security or in case they have been instructed how to use this device.
- Children are to be supervised in order to make sure that they do not play with this device.



**Caution!**  
**If you suffer from any type of skin disease or notice any changes consult a physician under all circumstances.**

## Design and installation of IR foils (heating mats):

Polyester foil / Polyester foil with aluminum heating element, heavy-metal free, excessive temperature thermostat at upper end of foil in silicone housing

Switch-off point = 120 °C

Switch-on point = 110 °C

40 mm wide edge without heating filaments all the way around for fastening foil.



### Caution!

The IR heating foils are intended only for installation in the infrared heat booth and should be operated only in combination with a control unit.

Any other type of use invalidates the guarantee.



### Caution!

The IR foils must only be installed vertically with the thermostat at the top end of the heating foil.

## Example of arrangement

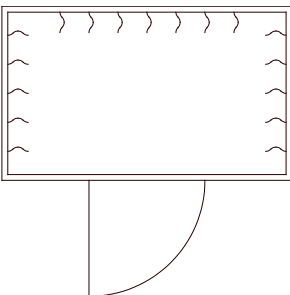

## Layout

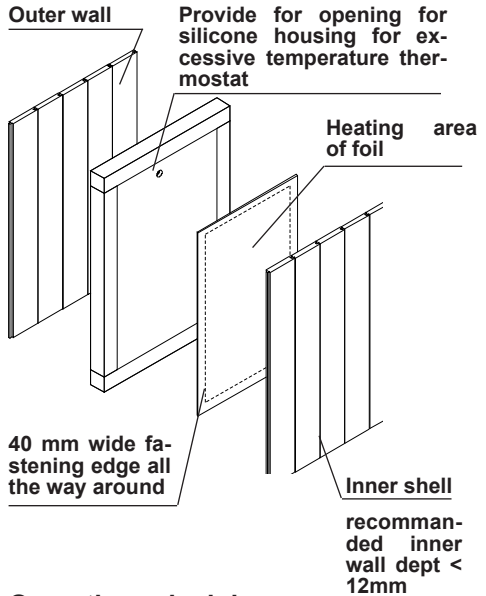

## Operating principle

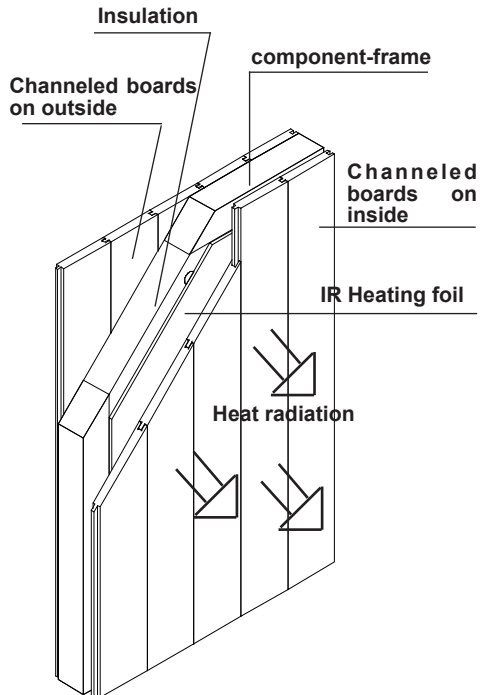



Caution! Never drive fastening elements (staples, pins, nails or screws) through the aluminum heating filaments

If the heating filament is interrupted, the heating foil no longer heats up!

When installing the silicone housing always ensure that the protective thermostat points up.

Never screw in screws in the area of the heating foils during final installation.

## Electrical connection

Take appropriate measures for pull relief on the feed lines for the foils (cable clamps). Plug the connection plugs for the IR heating foils into the distribution block on the control unit.



Caution! Observe maximum switching power for control unit.

## Possible connection schematic

Feed line

Control unit-  
max. 3500 W

Plug

IR heating  
foils

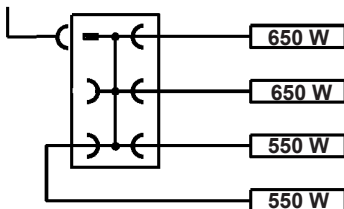

When installing route the connection leads through the empty conduit or take other suitable measures to prevent damage.

## Start-up

Start up with the associated control unit.

Note that this heating system has a certain "time delay". It is first necessary for the foils to heat up the channeled boards in front, before they can radiate heat into the booth. It is quite possible for the temperature at the surface of the wood on the inside of the booth to be higher than the room temperature inside the booth.

The primary effect of the infrared heat booth is its capability of radiating (infrared) heat to humans; the heat resulting in the room is a secondary, ancillary effect, which is, however, experienced as pleasant and does not have any negative effect on the treatment.

Please observe, that the IR heat booth is not a sauna with typical hot / cold treatments and that the temperatures present in a sauna cannot be achieved!

# Connection with InfraTouch

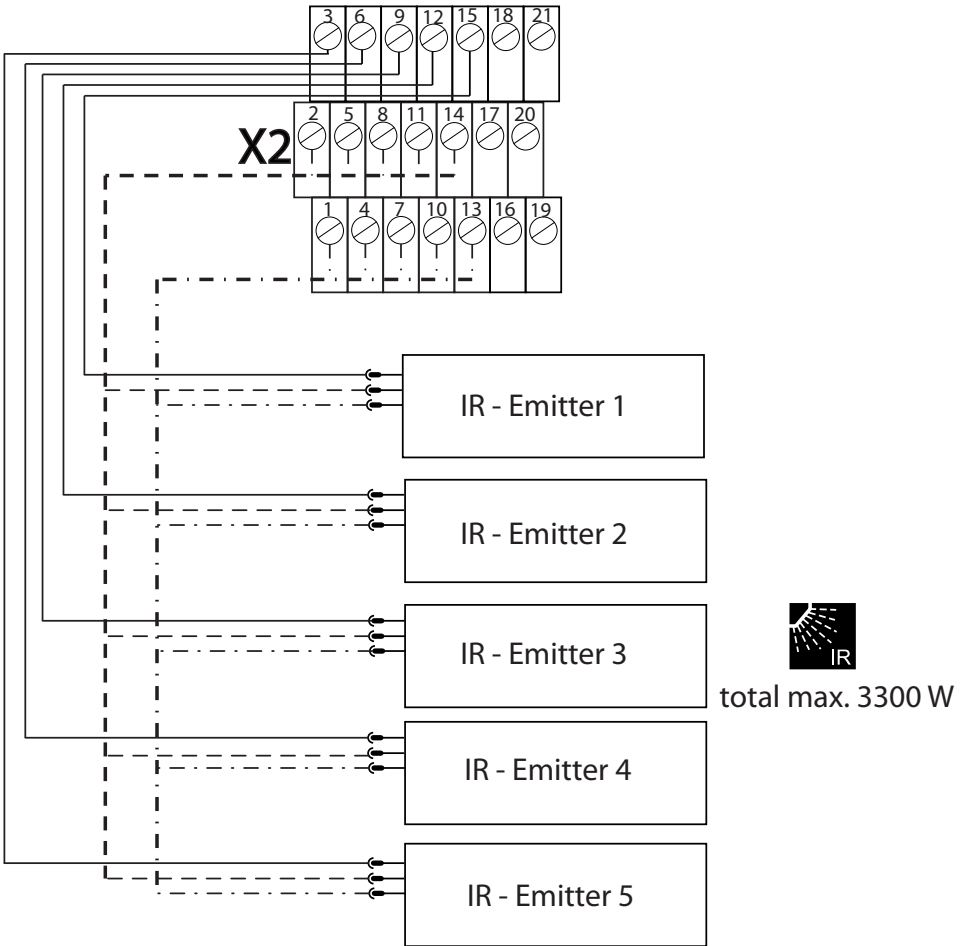

Please keep this address in a safe place together with the installation guide.

To help us answer your questions quickly and competently please provide the information printed on the type shield including the model, item no. and serial no., in all inquiries.

### **Service Address:**

EOS Saunatechnik GmbH  
Adolf-Weiß-Straße 43  
35759 Driedorf-Mademühlen, Germany  
Tel: +49 (0)2775 82-514  
Fax: +49 (0)2775 82-431  
servicecenter@eos-sauna.de  
www.eos-sauna.de

## **WARRANTY**

The warranty is provided according to the legal regulations at present.

Manufacturer's guarantee:

- The period of guarantee starts from the date of purchase and lasts up to 2 years by commercial use and 3 years by private use.
- Always include the completed guarantee certificate when returning equipment.
- The guarantee is void for appliances which have been modified without manufacturer's explicit agreement.
- Damages caused by incorrect operation or handling through non-authorized persons are not covered under the terms of guarantee.
- In the event of a claim please indicate the serial number as well as the item number and model name with detailed description of the fault.
- This guarantee covers defective parts and labour but not the defects caused by wear and tear.

In case of complaint please return the equipment in its original packaging or other suitable packaging (caution: danger of transport damage) to our service department.

Always include the completed warranty certificate when returning equipment.

Possible shipping costs arising from the transport to and from point of repair cannot be overtaken by us.

Outside of Germany please contact your specialist dealer in case of warranty claims. Direct warranty processing with our service department is in this case not possible.

Equipment commissioning date:

Stamp and signature of the authorized electrician:



## Handling procedures for return shipments (RMA) - Details for all returns !

Dear customer

we hope that you will rejoice in the ordered articles. Just in case that you are not entirely contented as an exception, please follow the procedures specified below. This enabling us to ensure a quick and smooth handling of the return shipment.

### Please absolutely respect for all returns!

- Please add the available **RMA-voucher** always **completely filled out** together with an **invoice copy** to the return shipment! Do not stick it on the goods or on the packaging. **We do not accept the return shipment without these papers.**
- Not prepaid parcels **will be refused** and returned to Sender! Please always ask for the **RMA-No.** for the cheapest return.
- **Please pay attention that** the goods have to be sent back **without visible marks of use** in the **original scope of delivery and in original packing.**
- We recommend to use an **additional solid and break-proof covering box** which should be padded out with styrofoam, paper or similar. Transport damages as a result of faulty packing are for the sender's account.

### Form of complaint:

#### 1) Transport damage

- Please check the content of your parcel immediately and advise the forwarding company of a claim (parcel service/ freight forwarder)
- Do not use damaged goods!
- Ask the forwarder **for a written acknowledgement of the damages.**
- **Report the claim promptly by phone to your dealer.** He will discuss with you how to act in this case.
- If the transport box has been damaged, please use an additional covering box. Do not forget to add the **acknowledgement of the damage of the forwarding company !**

#### 2) Faulty goods

- The implied warranty period is 2 years. Please contact your dealer in case of **faulty or wrong articles or missing accessories.** He will discuss with you the individual case and try for immediate and customer-friendly solution.
- For **economic returns** within Germany you will get an **RMA-number from the manufacturer.**
- All returns have to be in the **original packing of the goods with corresponding accessories.** Please repack the goods to avoid damages. In case of wrong delivery, please do not use this article !

#### 3) Problems of installation and functioning

- Please **read the manual carefully first of all** and pay attention to the indicated assembly or installing instructions.
- **Your dealer should be the first contact person** because he knows his products best and also knows possible problems.
- **In case of function problems with an article,** please check at first whether there is an obvious material defect. The quality system in our factory reduces malfunctions of new appliances to almost zero.